

# ANSI Pump Series

HEAVY-DUTY PROCESS PUMPS

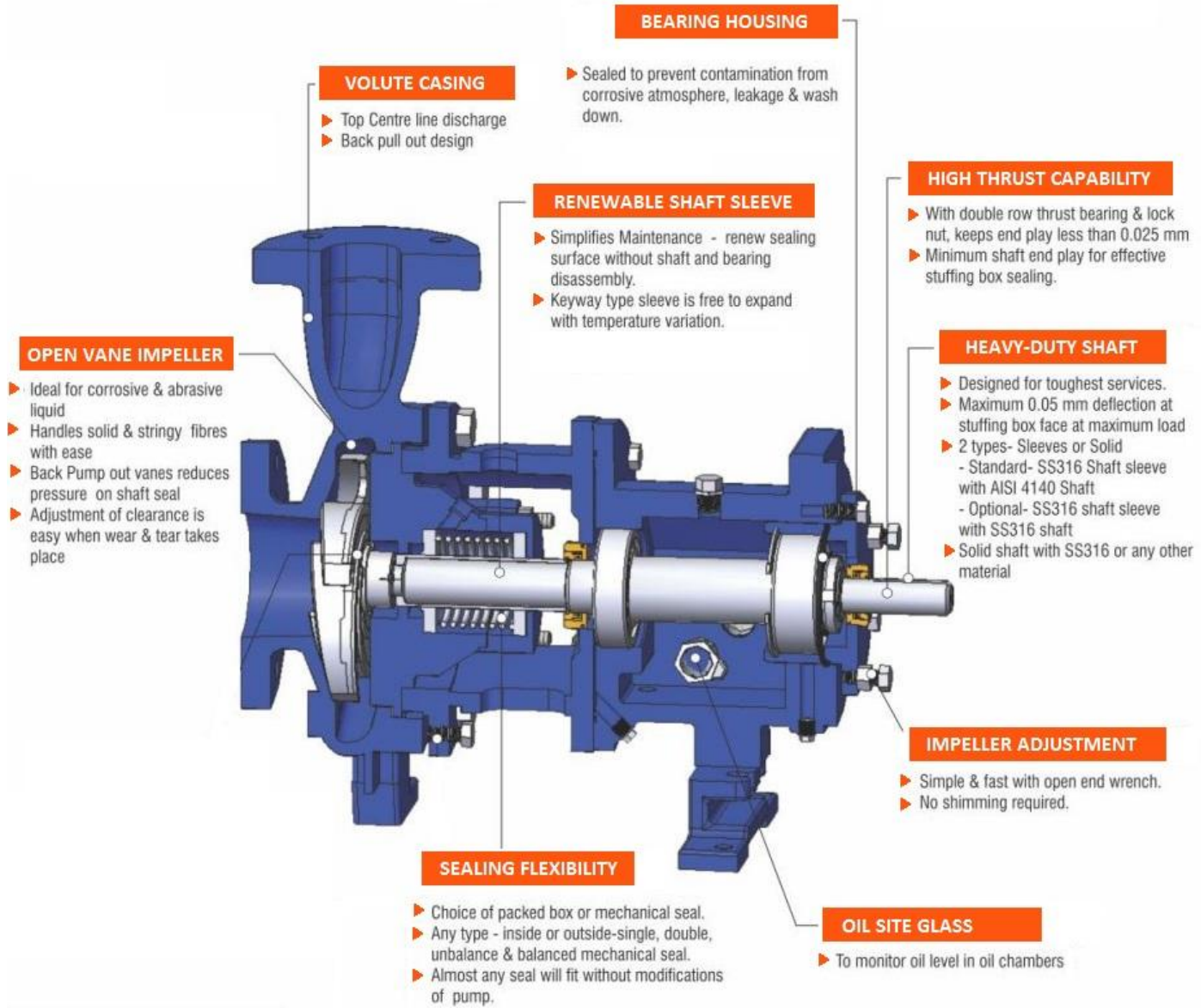

# DESIGN FEATURES



# GENERAL DIMENSIONS

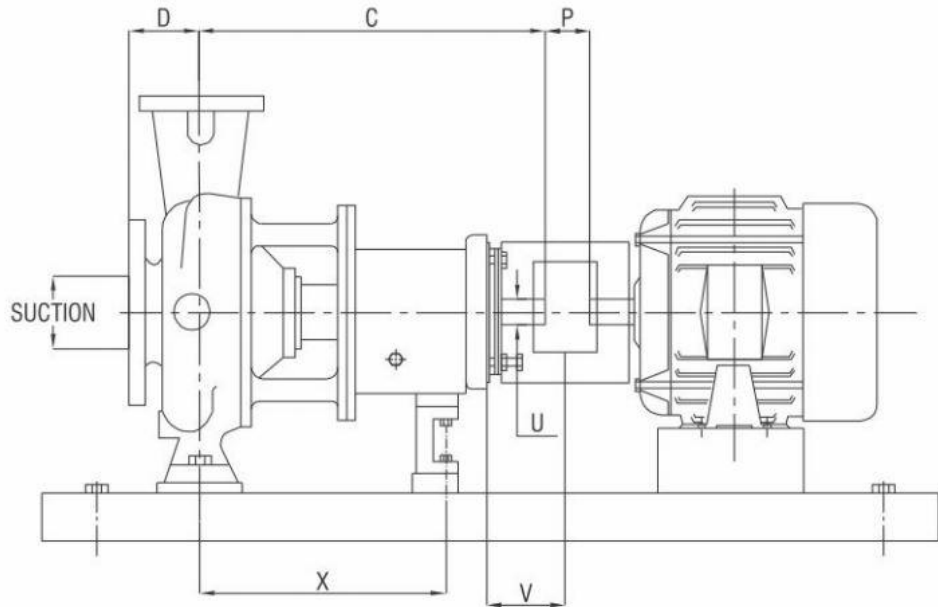
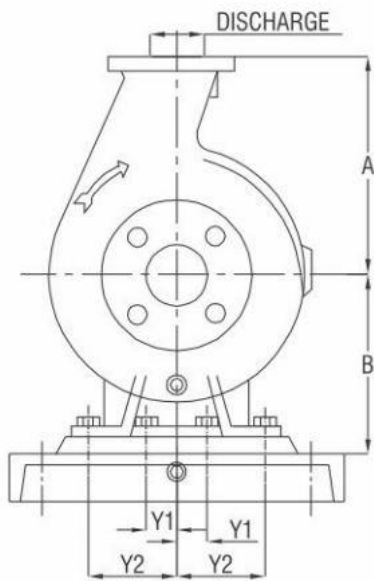

TYPE	PUMP SIZE	DISCHARGE	SUCTION	A	B	C	D	Y1	Y2	X	H	P	U	N	BARE PUMP WEIGHT LBS.											
XLI	1x1.5-6	1	1.5	6.5 (165)	5.25 (133)	13.5 (343)	4 (102)	0	3 (76)	7.25 (184)	5/8 (16)	3.75 (95)	0.875 (22)	2 (50)	85											
	1.5x3-6	1.5	3												94											
	2x3-6	2	3												96											
	1x1.5-8	1	1.5												102											
	1.5x3-8	1.5	3												110											
SIX OR LIX	3x4-7	3	4	11 (280)	8.25 (210)	19.5 (495)	4 (102)	3.625 (92)	4.875 (124)	12.5 (318)	5/8 (16)	3.75 (95)	1.125 (28.5) MTR OR 1.875 (47.6) LTR	2.625 (67)	222											
	2x3-8	2	3	9.5 (242)											222											
	3x4-8	3	4	11 (280)											222											
	3x4-8G	3	4	11 (280)											222											
	1x2-10	1	2	8.5 (216)											204											
	1.5x3-10	1.5	3	9.5 (242)											222											
	2x3-10	2	3	9.5 (242)											232											
	3x4-10	3	4	11 (280)											266											
	3x4-10H	3	4	12.5 (318)											276											
	4x6-10	4	6	13.5 (343)											10 (254)	14.5 (368)	6 (152)	4.5 (114)	8 (203)	18.75 (476)	7/8 (22)	5.25 (135)	2.375 (60)	4 (100)	308	
	4x6-10G	4	6																						248	
	4x6-10H	4	6																						278	
	1.5x3-13	1.5	3																						10.5 (267)	334
	2x3-13	2	3																						11.5 (292)	410
	3x4-13	3	4	12.5 (318)											19 (483)	27.875 (708)	6 (152)	4.5 (114)	8 (203)	18.75 (476)	7/8 (22)	5.25 (135)	2.375 (60)	4 (100)	560	
4x6-13	4	6	13.5 (343)	650																						
6x8-13	6	8	16 (406)	610																						
8x10-13	8	10	18 (457)	740																						
6x8-15	6	8	18 (457)	710																						
8x10-15	8	10	19 (483)	850																						
8x10-15G	8	10	19 (483)	830																						
8x10-15H	8	10	19 (483)																							
4x6-17	4	6	16 (406)																							
6x8-17	6	8	18 (457)																							
8x10-17	8	10	19 (483)																							



# EXPLODED PARTS LIST - XLI

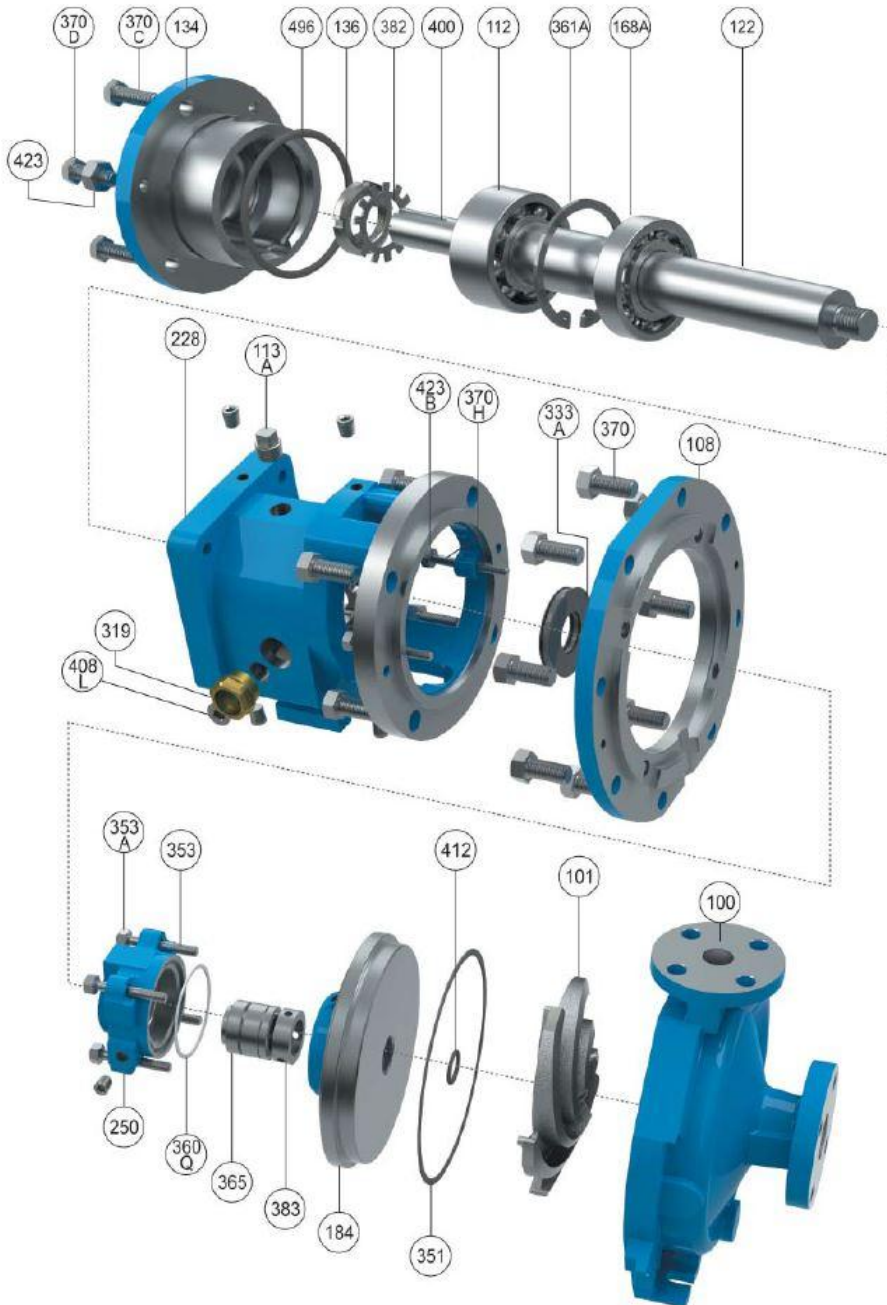

ITEM	QTY	DESCRIPTION
100	1	Casing
101	1	Impeller
108	1	Adapter, Ring
112	1	Bearing, Outboard
113A	1	Plug, Oil Fill
122	1	Shaft
126	1	Sleeve, Shaft
134	1	Housing, Bearing
136	1	Locknut, Bearing
168A	1	Bearing, Inboard
184	1	Cover, Stuffing Box
228	1	Frame
250	1	Gland, Mechanical Seal
319	1	Sight Glass
332A	1	Labyrinth, Outboard
333A	1	Labyrinth, Inboard
351	1	Gasket, Casing
353	4	Stud, Gland
353A	4	Nut, Gland
358A	1	Plug, Casing Drain
360Q	1	Gasket, Gland, Mech. Seal
361A	1	Snap Ring, Bearing
365	1	Seal, Mechanical Stationary Element
370	3	Bolt, Casing
370B	4	Bolt, Frame / Adapter
370C	3	Bolt, Bearing Housing
370D	3	Jack Bolt, Bearing Housing
370H	2	Stud, Stuffing Box Cover / Adapter
382	1	Lockwasher, Bearing
383	1	Seal, Mechanical Rotating Element
400	1	Key, Coupling
408A	1	Plug, Frame Lubrication Port
408L	1	Plug, Oil Cooler Inlet
408M	1	Plug, Oil Cooler Outlet(Not Shown)
412	1	O-ring, Impeller
423	3	Jamnut, Bearing Housing / Frame
423B	2	Nut, Box Cover / Adapter Stud
496	1	O-ring, Bearing Housing / Frame
500	1	Pin, Sleeve(Not Shown)

# EXPLODED PARTS LIST - SIX

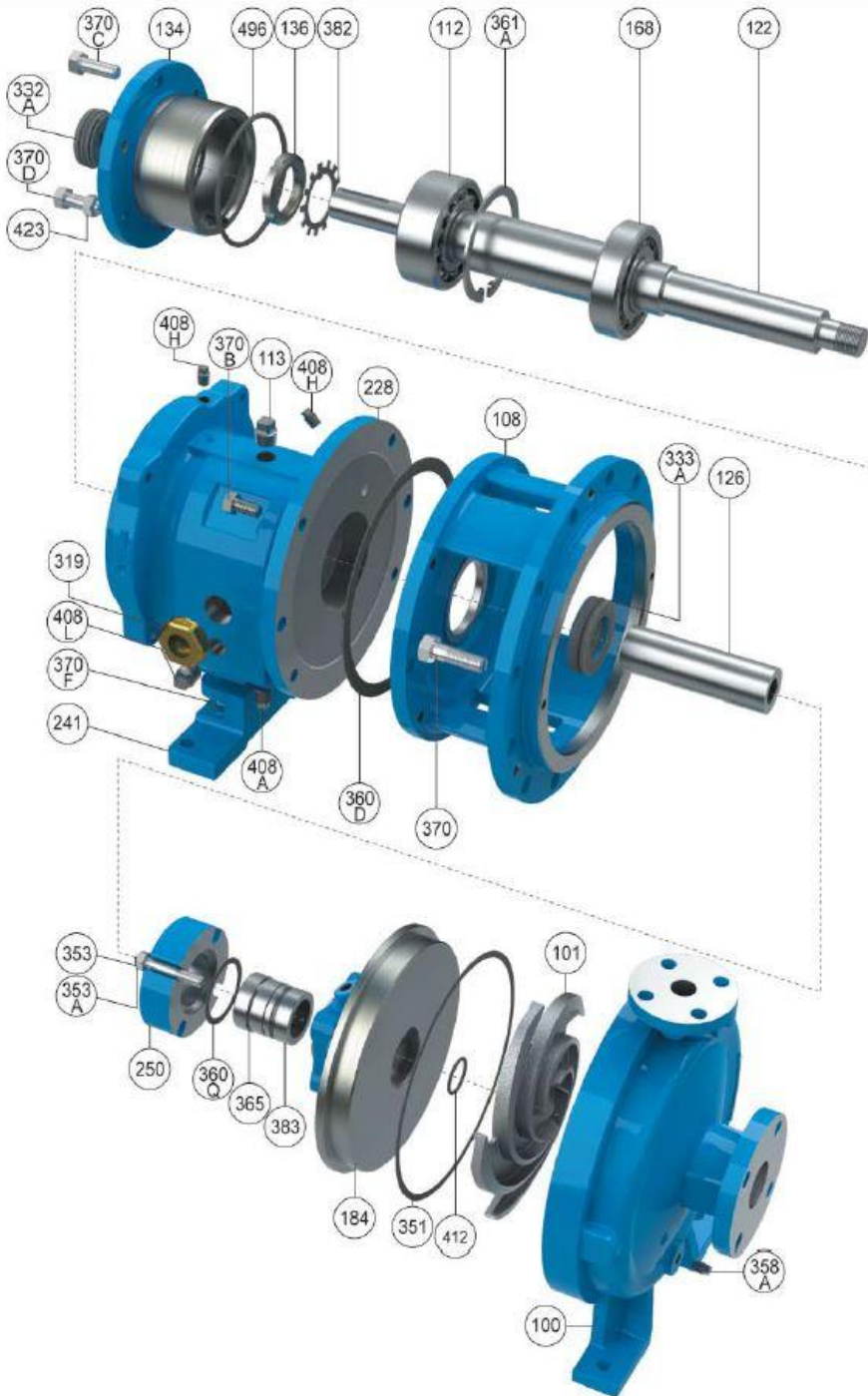

ITEM	Q'TY	DESCRIPTION
100	1	CASING
101	1	IMPELLER
108	1	ADAPTER
112	1	BEARING,OUTBOARD
113	1	PLUG, OIL FILL
122	1	SHAFT
126	1	SLEEVE, SHAFT
134	1	HOUSING, BEARING
136	1	LOCKNUT,BEARING
168	1	BEARING, INBOARD
184	1	COVER, STUFFING BOX
228	1	FRAME
241	1	FOOT, FRAME
250	1	GLAND*, MECHANICAL SEAL
319	1	GAUGE,SIGHT, OIL
332A	1	LABYRINCH, OUTBOARD FRAME
333A	1	LABYRINCH, INBOARD FRAME
351	1	GASKET, CASE
353	4	STUD, GLAND
353A	4	NUT, GLAND
358A	1	PLUG, CASING DRAIN
360D	1	GASKET, FRAME / ADAPTER
360Q	1	GASKET, GLAND / COVER
361A	1	SNAP RING, BEARING
365	1	SEAL*,MECHANICAL STATIONARY ELEMENT
370	8,12,16	BOLT, CASING
370B	4	BOLT, FRAME / ADAPTER
370C	3	BOLT, FRAME / BEARING HOUSING
370D	3	JACK BOLT, BEARING HOUSING
370F	2	BOLT, FRAME FOOT
370H	2	STUD, BOX COVER / ADAPTER(NOT SHOWN)
382	1	LOCK WASHER, BEARING
383	1	SEAL*, MECHANICAL ROTATING ELEMENT
400	1	KEY, COUPLING (NOT SHOWN)
408A	1	PLUG, FRAME DRAIN
408H	4	PLUG, FRAME LUBRICATION PORT
408L	1	PLUG, OIL COOLER INLET
408M	1	PLUG, OIL COOLER OUTLET(NOT SHOWN)
412	1	O-RING, IMPELLER
423	3	JAM NUT, BEARING HOUSING JACK BOLT
423B	2	NUT, COVER / ADAPTER STUD(NOT SHOWN)
469B	2	DOWEL PIN, FRAME / ADAPT.(NOT SHOWN)
496	1	O-RING, BEARING HOUSING / FRAME
529	2	WASHER, FRAME FOOT BOLT (NOT SHOWN)

\* STUFFING PACKING TYPE BY OPTION



# SELECTION CURVES

